



Farmers Electric Cooperative

A Touchstone Energy[®] Cooperative 

301 N. Hillcrest
Sulphur Springs, TX 75482

2000 I-30 E
Greenville, TX 75402

108 W. Marble
Wylie, TX 75098

Wednesday, July 31, 2019

Office of Hopkins County Judge
PO Box 288
Sulphur Springs TX 75483

Farmers Electric Cooperative Member: MARY AMES
Service Order Number: 1907004539

Greetings:

Farmers Electric Cooperative, Inc. is requesting permission to construct electrical power distribution facilities which will cross County Road 3542 which is located approximately 1670 ft north of CR 3546 in Hopkins County, Texas.

Site location map and construction sketches are enclosed. The construction sketch details the proposed work. All road crossings will have a minimum vertical clearance of 22 feet.

If you have any questions, please contact me at any time.

Sincerely,

Matthew Walker

Project Coordinator
mwalker@farmerselectric.coop
Phone 903-441-1368

Submitted by Brandon Darrow
bdarrow@farmerselectric.coop
Field Engineering Coordinator

Enclosures

County Approval Section:

Approved:

Denied:

Authorized Signature: *Wade Bentley*

Date: 8-1-19

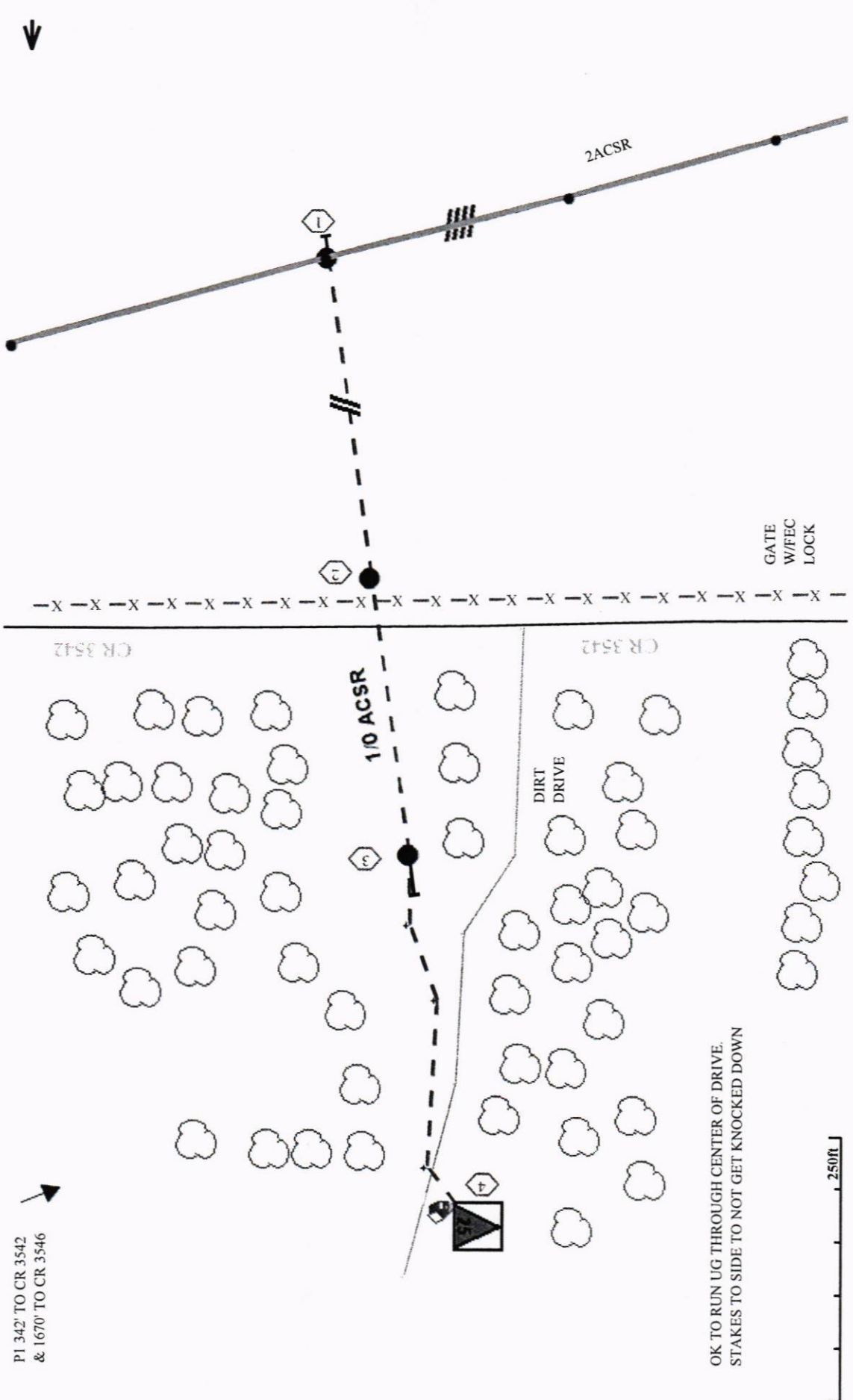

P1 342' TO CR 3542
& 1670' TO CR 3546

OK TO RUN UG THROUGH CENTER OF DRIVE.
STAKES TO SIDE TO NOT GET KNOCKED DOWN

250ft

Mary Ames
Service
Order#1907004539
Set pole in line and
cross CR 3542.



County Road 3542

County Road 3542

SUBSIST SERVICE AREA



County Road 3542

County Road 3546

